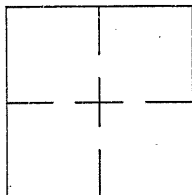

## CORNER RECORD

Document Number CR 5793City of OAKLANDCounty of ALAMEDA, CaliforniaBrief Legal Description CITY OF OAKLAND BENCHMARK #2912 CITY ENGINEER'S OFFICE  
OAKLAND, CALIFORNIA

## CORNER RECORD

COORDINATES  
(Optional)

Government Corner ☐ Control ☐  
 Meander ☐ Property ☐  
 Rancho ☐ Other ☒ BM  
 Date of Survey 7/21/13

N. \_\_\_\_\_  
 E. \_\_\_\_\_  
 Zone \_\_\_\_\_ Datum \_\_\_\_\_  
 Elev. \_\_\_\_\_

Corner — Left as found ☐ Found and tagged ☐ Established ☐ Reestablished ☒ Rebuilt ☐

Identification and type of corner found: Evidence used to identify or procedure used to establish or reestablish the corner:  
FOUND CITY OF OAKLAND BENCHMARK #2912. CUT SQUARE IN TOP OF CURB C/L "B"  
INLET MID POINT RETURN N/E CORNER SKYLINE BLVD AND BROOKPARK RD.

THIS POINT WAS REFERENCED PRIOR TO A CONSTRUCTION PROJECT IN THE VICINITY.

A description of the physical condition of the monument as found and as set or reset:  
FOUND AND SET POINTS AS SHOWN ON PAGE 2.

THESE TIES ARE FOR THE PURPOSE OF PERPETUATING THE FOUND MONUMENTATION.

## SURVEYOR'S STATEMENT

This Corner Record was prepared by me or under my direction in conformance with  
 the Land Surveyors' Act on August 19, 2013.

Signed Vincent H. Cunha L.S. Number LS 4520  
 VINCENT H. CUNHA

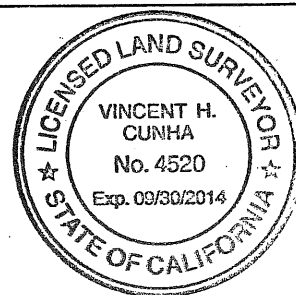

## COUNTY SURVEYOR'S STATEMENT

This Corner Record was received 8-20-13 and examined  
 and filed 9-15-2013

Signed Russell R. Penland Title County Surveyor

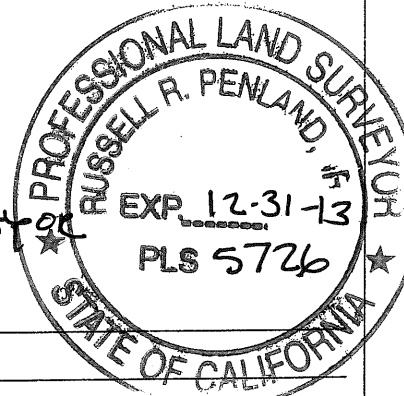

County Surveyor's Comment \_\_\_\_\_

## LEGEND

- FOUND CITY OF OAKLAND BENCHMARK #2912  
CUT SQUARE IN TOP OF CURB C/L "B" INLET
- ⊙ SET 2" BRONZE LEVELING DISK IN TOP OF CURB  
STAMPED CITY OF OAKLAND BENCHMARK

SET 2" BRONZE LEVELING DISK  
IN TOP OF CURB  
43'± NORTHEASTERLY FROM  
THE EASTERLY RETURN OF THE  
NORTH CORNER SKYLINE BLVD  
AND BROOKPARK RD  
EL=1118.558'

FOUND CITY OF OAKLAND  
BENCHMARK #2912  
EL=1114.160'

BROOKPARK  
ROAD

SKYLINE

BOULEVARD

CHAPPEL  
PLACE

SCALE: 1"=30'