

County Surveyor's Office  
Stanislaus County Cal.

Swamp and Overflowed Lands.

Survey No.: 200

Township, 2 South

Range, 8 East.

Sections 24 and 25.

Tract S.E.  $\frac{1}{4}$  of the S.W.  $\frac{1}{4}$ , and Tract S.W.  $\frac{1}{4}$  of the S.W.  $\frac{1}{4}$  of Sec. 24; Tract N.E.  $\frac{1}{4}$  of the N.W.  $\frac{1}{4}$ , and Tract N.W.  $\frac{1}{4}$  of the N.W.  $\frac{1}{4}$  of Sec. 25.

Base and Meridian of Mount Diablo

Containing: 37.62 Acres

Surveyed, December 22<sup>nd</sup> 1863.

for

Leonard O. Brewster.

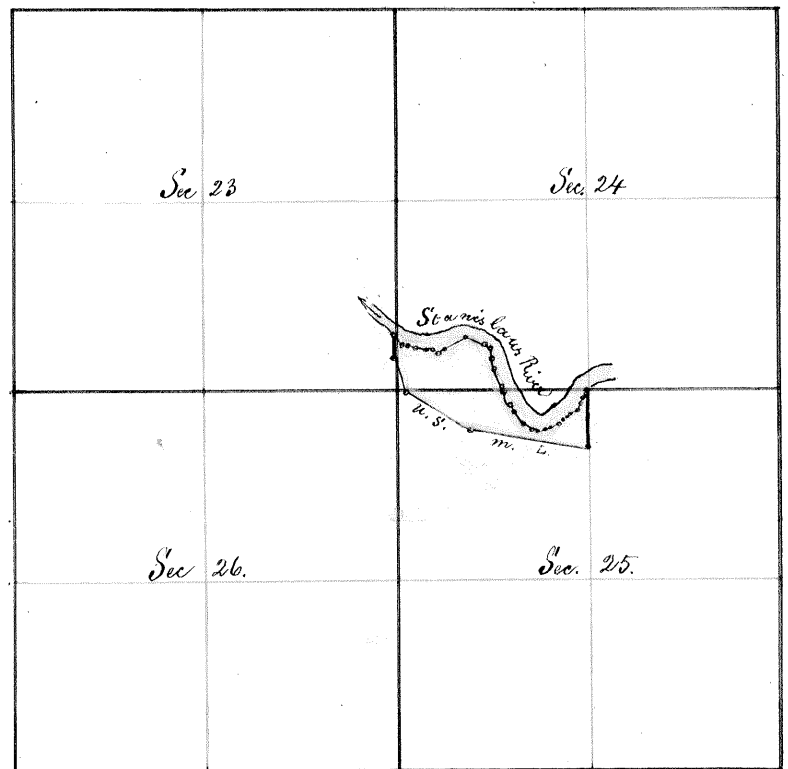

Field Notes.

Beginning at the intersection of the West boundary of Section 24 T. 2 S. R. 8 East of Mount Diablo Base and Meridian, with the left bank of the Stanislaus river, thence meander up stream S  $49^{\circ}$  E 2.50 chains, S  $81^{\circ}\frac{1}{2}$  E 1.00 ch, S  $78^{\circ}\frac{1}{2}$  E 1.90 chs, S  $86^{\circ}$  E 1.00 ch, N  $72^{\circ}\frac{1}{2}$  E 1.25 chs, N  $73^{\circ}$  E 0.80 ch, N  $55^{\circ}$  E 5.61 chs, S  $64^{\circ}\frac{3}{4}$  E 4.36 chs, S  $35^{\circ}$  E 1.30 chs, S  $19^{\circ}\frac{1}{2}$  E 1.50 chs, S  $6^{\circ}\frac{1}{2}$  E 2.25 chs, S  $17^{\circ}$  E 4.20 chs, S  $3^{\circ}\frac{1}{2}$  E 1.00 ch, S  $23^{\circ}\frac{1}{4}$  E 3.25 chs, S  $31^{\circ}\frac{3}{4}$  E 2.80 chs, S  $27^{\circ}\frac{3}{4}$  E 3.15 chs, S  $49^{\circ}\frac{3}{4}$  E 3.00 chs, N  $84^{\circ}$  E 1.10 chs, N  $80^{\circ}\frac{1}{2}$  E 1.19 chs, N  $78^{\circ}$  E 1.10 chs, S  $71^{\circ}$  E 0.50 chs, N  $67^{\circ}\frac{1}{2}$  E 1.50 chs, N  $53^{\circ}\frac{1}{2}$  E 3.50 chs, N  $41^{\circ}\frac{1}{4}$  E 1.50 chs, N  $25^{\circ}\frac{3}{4}$  E 1.10 chs, N  $18^{\circ}$  E 1.47 chs, to the intersection with the North and South line between the N.E. and N.W.  $\frac{1}{4}$  of Section 25; thence South 11.57 chs, to (thence along the U.S. meander line) Post set at intersection with the U.S. Meander line down stream, N  $79^{\circ}\frac{3}{4}$  W 23.49 chs, N  $59^{\circ}\frac{1}{4}$  W 15.00 chs, N  $30^{\circ}$  W 8.00 chs, to U.S. Meander Post on the West boundary of Section 24, thence North 4.40 chs, to point of beginning

Run by the true Meridian: Magnetic Variation  $15^{\circ} 42'$  East.

Surveyed in accordance with the Act of the Legislature, concerning State Lands approved April 27<sup>th</sup>, 1863, and the instruction of the Surveyor General.

Approved June 23<sup>rd</sup> 1864

J. D. Houghton  
Surveyor General  
by A. L. Bender

Deputy

Approval Recorded August 12<sup>th</sup> 1864

A. G. Stakes  
Co. Surveyor

E. B. Beard  
Co. Surveyor Stanislaus Co.  
By A. G. Stakes  
Deputy