

# RECORD OF SURVEY

COUNTY OF MONO STATE OF CALIFORNIA

## RS 34-60 (AMENDED)

N-N/64 COR. S 13/18  
FD 1 1/2" O.D.I.P.  
W/TAG RCE 27104.  
PER RS 34-12 FILED  
IN RS BK 1, PG. 68  
MONO COUNTY.  
N 2203211.54  
E 6947698.36

P.M. 57.69  
1" IP W/ALUM CAP  
N 2203169.39  
E 6948177.57

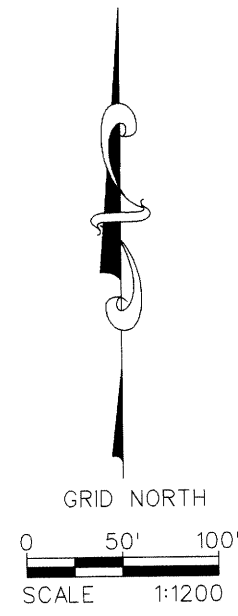

MAPPING ANGLE AT PM 57.27 = 0°49'20"  
CALIFORNIA COORDINATE SYSTEM (1983), ZONE 3  
GEODETIC AZIMUTH = GRID AZIMUTH + MAPPING ANGLE  
COMBINED GRID FACTOR = 0.9996274

NOTE:  
ALL VALUES ON THIS MAP ARE GRID, UNLESS OTHERWISE NOTED.  
TO OBTAIN A GROUND DISTANCE, DIVIDE THE GRID DISTANCE  
BY THE GRID FACTOR.

### LEGEND

- ⊙ INDICATES A SET CADT 2 1/4" DIA. BRASS CAP ON A 1" ODIP, IN CONC., STAMPED AS NOTED.
- INDICATES AN ANGLE POINT ON THE RIGHT-OF-WAY, NOTHING SET.
- ▽ INDICATES A SET PROJECT CONTROL MONUMENT, DESCRIBED AS NOTED.
- INDICATES A FOUND NGS MONUMENT, DESCRIBED AS NOTED.
- ( ) INDICATES RECORD GROUND INFORMATION AS PER RS 34-39, FILED IN RECORD OF SURVEY BOOK 2, AT PAGE 94, IN THE OFFICE OF THE MONO COUNTY RECORDER. CERTIFICATE OF CORRECTION FILED MARCH 29, 1993 ON SAID RS MAP.
- ◆ INDICATES A FOUND LAND NET CORNER, DESCRIBED AS NOTED.
- INDICATES A FOUND 6" x 6" CONCRETE RIGHT-OF-WAY MONUMENT.
- INDICATES A SET MONUMENT AS NOTED.
- RIGHT-OF-WAY PER CALTRANS RIGHT OF WAY RECORD MAPS.

N00°4'43"W 5233.41'  
N00°40'42"W 4579.19'

R 25 E

SEC. 18

T 2 N, R 26 E, MDB&M

MNO 395

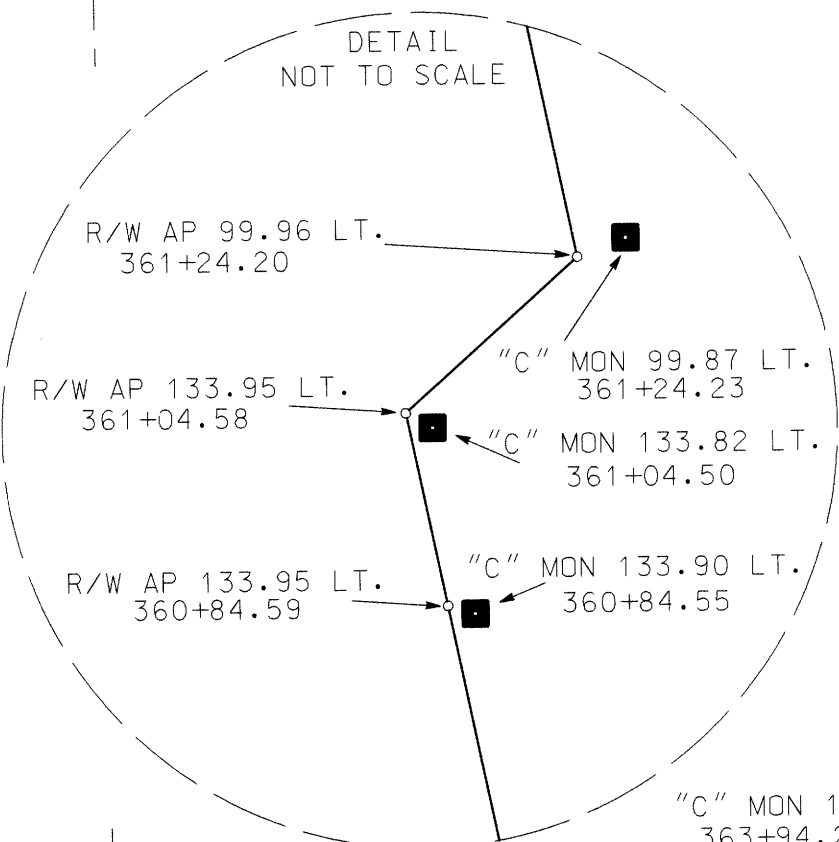

SEE DETAIL

"C" MON 100.07 LT.  
363+94.23  
R/W AP 129.95 LT.  
366+94.24  
"C" MON 130.05 LT.  
363+94.24

S78°15'12"W  
29.99'  
R/W AP 99.96 LT.  
366+94.24

N48°15'12"E  
39.25'

N11°44'48"W  
19.99'

R/W AP 67.97 RT.  
361+24.20  
"C" MON 69.94 RT.  
361+24.21

N71°44'48"W  
39.24'  
R/W AP 103.96 RT.  
361+04.58  
"C" MON 103.87 RT.  
361+04.54

N11°44'48"W  
19.99'

"C" MON 103.96 RT.  
360+84.59 (R/W AP)

N48°15'12"E  
39.25'

"C" MON 69.97 RT.  
360+64.96 (R/W AP)

NW COR. MATERIALS SITE.  
SET 1" I.P. WITH AL. CAP  
STAMPED MS # 156-1  
N 2201257.12  
E 6949032.96  
355+03.30 498.89 RT.

N89°38'49"E  
1311.99'

"C" MON 69.97 RT.  
354+95.24 (R/W AP)

SET 1" I.P. WITH AL. CAP  
STAMPED MS # 156-6

"C" MON 49.98 RT.  
354+95.24 (R/W AP)

N78°15'12"E  
19.99'

R/W AP 135.95 LT.  
356+40.00 P.O.T.

S78°15'12"W  
33.99'  
R/W AP 99.96 LT.  
356+40.00 P.O.T.

355+00 R/W  
N 2201158.78  
E 6948543.85

P.M. 57.27  
1" IP W/ALUM. CAP  
N 2200988.29  
E 6948482.20