

**BASIS OF BEARINGS**  
FOR THIS SURVEY IS SOUTH 14°15'20" EAST, BEING  
THE BEARING BETWEEN THE TWO FOUND MONUMENTS  
ON THE EAST SIDE OF THE LOT SURVEYED ON THIS  
MAP. PER 119 M 52.

LEGEND

- FOUND AS NOTED
- SET 5/8" REAR W/ PLASTIC CAP  
LS 5571 UNLESS OTHERWISE NOTED
- R-1 119 N 52
- DD-1 DOC# 19736238
- ( ) RECORD INFORMATION

Email: [kenw@wilsonlandsurveys.com](mailto:kenw@wilsonlandsurveys.com)  
[www.wilsonlandsurveys.com](http://www.wilsonlandsurveys.com)

[www.wilsonlandsurveys.com](http://www.wilsonlandsurveys.com)

**KEN WILSON**

LS 5571

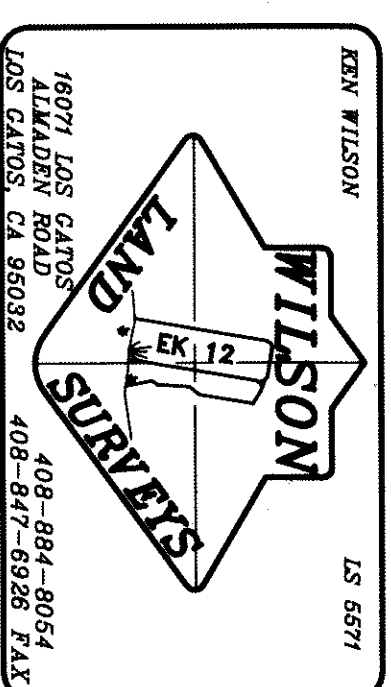

THIS MAP CORRECTLY REPRESENTS A SURVEY MADE BY ME OR UNDER MY DIRECTION IN CONFORMANCE WITH THE REQUIREMENTS OF THE PROFESSIONAL LAND SURVEYORS ACT AT THE REQUEST OF JUN WENGEN IN JUNE 2012.

10-7-12  
H. D. WILSON LS 5571

THIS MAP HAS BEEN EXAMINED IN ACCORDANCE WITH SECTION 8766 OF THE PROFESSIONAL LAND SURVEYORS ACT THIS 12TH DAY OF DECEMBER 20 12.

ACT THIS 12TH DAY OF DECEMBER 20 12.

2000

FILED THIS 14<sup>th</sup> DAY OF December 20 12 AT  
2:33 P.M. IN BOOK 858 OF MAPS AT PAGE 7,

AT THE REQUEST OF KENNETH D. WILSON.  
FILE NO. 22004900 FEE \$8.00

FILE NO. 22009900 FEE 18.00

RECORDED REGINA

Deputy

AS REQUESTED BY:  
**JUN WENREN**

LEGAL DESCRIPTION: LOT AS DESCRIBED IN DOCUMENT#  
19736238, CITY OF SARATOGA, COUNTY OF SANTA  
CLARA, STATE OF CALIFORNIA.

DATE: MAY 2012

FILENAME: C-068 WENREN RECORD OF SURVEY  
FIELD BOOK:

DRAWN BY:	SCALE:	PROJECT:	JOB NUMBER:	SHEET:
KTW	1"=30'	C-068	C-068	1 OF 1

COUNTY GRID NO.: 111-22-59

22004900