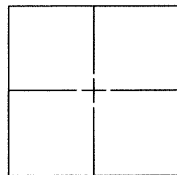

BK 89 PG 22**CORNER RECORD**

Document Number

CR 9250City of SAN LEANDROCounty of ALAMEDA

, California

Brief Legal Description INTERNATIONAL BLVD. AND 96TH AVE.**CORNER TYPE**Government Corner ☐ Control ☒Meander ☐ Property ☐Rancho ☐ Other ☐Date of Survey 10/18/2016**COORDINATES (Optional)**

N. _____

E. _____

Zone _____ NAD27 ☐ NAD83 ☐

NAD83 Epoch _____

Elev. _____

Vet. Datum: NGVD29 ☐ NAVD88 ☐Meas. Units: Metric ☐ Imperial ☒
Corner — Left as found ☒ Found and tagged ☐ Established ☐ Reestablished ☐ Rebuilt ☐

Identification and type of corner found: Evidence used to identify or procedure used to establish or reestablish the corner:

FOUND 1/4" IRON PIN IN CONCRETE. LOCATED IN MONUMENT WELL AT THE INTERSECTION OF 96TH AVE. AND
INTERNATIONAL BLVD.

A description of the physical condition of the monument as found and as set or reset: _____

SET NAIL AND TAG, STAMPED LS 8593 AS REFERENCE POINTS TO BE USED TO RESET MONUMENT SHOULD IT
BE DISTURBED DURING CONSTRUCTION ACTIVITIES.
SEE SHEET 2 FOR GRAPHIC**SURVEYOR'S STATEMENT**

This Corner Record was prepared by me or under my direction in conformance with

the Land Surveyor's Act on OCTOBER 19, 20 16Signed [Signature] P.L.S. or R.C.E. No. _____ L.S. # 8593**COUNTY SURVEYOR'S STATEMENT**This Corner Record was received 3 NOVEMBER 20 16and examined and filed 20 DECEMBER 20 16Signed Michael Rubner P.L.S. or R.C.E. No. 6843Title COUNTY SURVEYOR

County Surveyor's Comment: _____

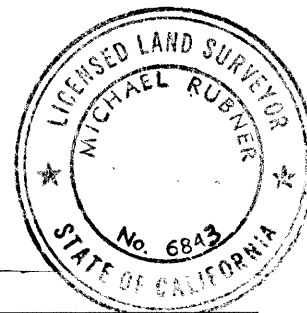
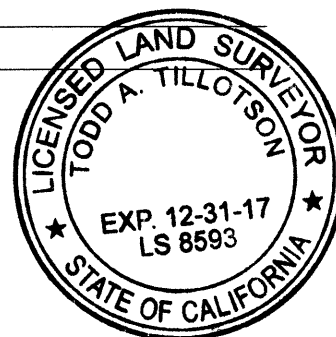
PG55D5

