

Swamp and Overflowed Lands  
Stanislaus County

© Township 3 South Range 10 East

Base and Meridian of Mount Diablo

Sec 33 Continuation of E.raction  
6 Sec 33 Area 40.60

Surveyed for Henry Shaw by  
Giles Wilcox County Surveyor

Field notes of the above Survey made on  
the 21<sup>st</sup> day of July 1856

Beginning at a Post at the South East Corner  
of Sec 33 thence N 55° E 23 chs to Meander Post  
thence meander down Stream first  
first S 77° W 15 chs thence N 24° 15' W 21 chs thence  
N 45° 15' W 2 chs thence N 71° 15' W 3 chs thence  
S 31° W 2 chs thence S 18° 30' W 6 chs thence  
S 12° 45' W 20.13 thence S 68° 15' W 5.50 thence  
South 12.20 chs to quarter Sec Post  
thence East 40. chs to the place of  
beginning Containing in the Continuation  
40.60 Acres of Eraction 6 Sec 33  
Township 3 South Range 10 East

Surveyed with a Magnetic Variation  
of 15° 25' East according to the  
U.S. Survey

Henry Shaw  
 Plat of Survey No 58  
 Township 3 South Range 10 East  
 Sec 33 Continuation of fraction 6

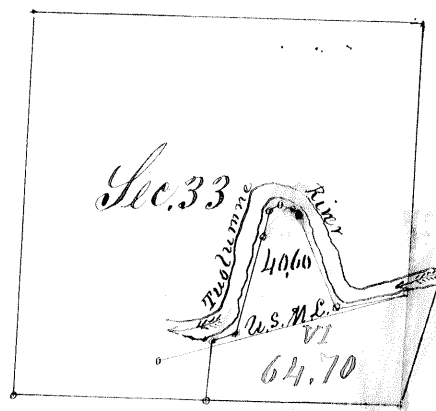

Var 13-23-

Scale two inches to one mile

No 113

Page 264

I hereby certify<sup>2</sup> the foregoing Survey  
 was made in accordance with the  
 Act of the Legislature and with  
 the instructions of the Surveyor  
 General of this State  
 Silas Wiley  
 County Surveyor

Swamp & Overflowed Lands

Stanislaus County Survey No 58

Base and Meridian of Mount Diablo

Township 3 South Range 10 East

Sec 33 the Continuation of Section 6

Area 110.60 Acres

Surveyed for Henry Shaw

By Silas Wilcox County Surveyor

Field notes of the above made on the 21 day July 1856.

Beginning at M. P. between Sec. 33 & 34 on the left Bank  
of the Toulumne River thence Meander down stream  
first S 77° W 15 chs thence N 24° 15' W 1 chs thence N 45° 45' W 1 chs thence N 71°  
15' W 3 chs thence S 6° W 2 chs thence S 63° 30' W 1 chs thence S 2° 45' W 20.13 chs  
thence S 68° 15' W 3 chs to the U. S. M. L. thence N 71° E 2 chs to the  
place of beginning. Containing 110.60 Acres

Surveyed by the true Meridian with a magnetic variation  
of 15° 25' East according to the U. S. Survey

I hereby Certify that the foregoing field notes to be  
a Corrected Copy of Survey No 58 made under the instruction  
from the Surveyor General of this State  
this the 25 Dec. 1856

Silas Wilcox  
County Surveyor